



Cabinet Accessories

> Kitchen, Laundry & Bathroom



Cabinet Accessories

More than just kitchen accessories, Lincoln Sentry's range of cabinet accessories suit a variety of applications for Kitchens, Bathrooms and Laundries. Here at Lincoln Sentry our range of products are not only of high quality, they also have purpose, design and are complementary to the overall look and feel of your home.



Romagna

Celebrating their 40th Anniversary, Romagna Plastics is a leader of built-in kitchen furniture. Their growing range of waste management options have a focus on elegance, design and functionality whilst showing uncompromising attention to detail, are simple to assemble and have long term reliability.

Lincoln Sentry is a proud partner with Romagna Plastics in promoting the new 560 Waste Management Integrated Drawer program providing a contemporary and flexible waste management solution that can be quickly and easily installed. The individual bins are supplied with their own lids to minimise odours.

The range of configurations enables you to meet your everyday demands of disposing general waste and recycling to assist in maintaining cleanliness whilst fulfilling the aesthetic look and feel of your kitchen.

KitVac

KitVac is an inbuilt cupboard ducted vacuum system that is easy to use, convenient and compact. Exclusively distributed by Lincoln Sentry in Australia, the white KitVac vacuum system offers high performance suction, and a soft-start motor allowing the activation of the unit once the dustpan kick is pushed or the expansion hose is inserted in the housing on the unit.

Agoform



Efficient and organised cutlery trays complete your functional space in the home or commercial kitchen. Agoform's Scoop II Cutlery Trays are produced from high impact polystyrene that can be used not just in the kitchen but also in areas of everyday life wherever organising cutlery, stationery and manual tools is required. Complementing the Scoop II Cutlery Trays are the Slot-in Divider Sets to work with your individual requirements.

Finista



Finish your next project with style by integrating the new Finista range of products from Lincoln Sentry. Finista is a range of stylish solutions for the kitchen, bathroom, wardrobe, laundry and office. This new range of Finista products have been sourced from all over the globe and will allow you to offer your customers a selection of products that will "finish with style" your next project.

Echelon



bottle storage system

The Echelon wine rack is a unique S-shaped module made from aluminium extrusion coated with a natural satin anodising that slides and snaps together to form the cavity of one bottle and top for the next bottle. The system is very space efficient with a capacity of over 90 bottles per square metre.



Contents

Waste Management Solutions

560 Waste Management Systems	4
SERVO-DRIVE uno	9
Stand In Drawer Systems	10
Free Standing Pull Out Systems	11
Door & Bench Systems	13
KitVac Cupboard Vacuum System	14



Waste Management Solutions

Organisation Solutions

Cutlery Trays	16
Spice Racks	18
Non Slip Drawer Liner & Surface Saver	19
Pullout & Foldaway Fittings	20
Fridge Door Mounting Mechanism	20
Hanging Rail System	21
Tea Towel Rails	22



Organisation Solutions

Storage Solutions

Storage Units & Racks	23
Wine Storage Solutions	
Wine Glass Storage Solutions	24
Wine Bottle Storage Solutions	25



Storage Solutions

Kitchen & Laundry Solutions

Ironing Boards	27
Laundry Accessories	28
Vents	31



Kitchen & Laundry Solutions



560 Waste Management System

- European made
- Maximise space within your carcass with a bin at the top or bottom

Optional:

- Designed to suit Blum TANDEMBOX antaro and TANDEMBOX intivo
- Improve performance with SERVO-DRIVE by Blum
- Metal carcass lid to combine with individual bin lids to minimise odours
- 300mm to 900mm carcass width options available
- 3 bucket heights



Features	Benefits
Buckets at top of drawer profile	Aesthetically pleasing, nowhere for waste to gather
Different capacity size bins	Options and combinations
Individual bin lids	Minimises odours
Combined metal & plastic frame	Strength and stability
Grey matt finish	Design and aesthetically appealing
2 x Additional front fixing brackets	Additional front panel stability to ensure alignment
500 & 450 Nominal length options	Increased design options, especially in sink applications due to waste pipes

Waste Management Solutions

Top Hung Drawer 560 Waste Management Systems - To suit 500 NL

- Drawer not included with 560 waste codes
- Please select from the **TANDEMBOX 'M'** height drawer kits below

TANDEMBOX Program	Finish	Drawer Capacity	Code
antaro	Silk White	30kg	1-243-015
	Silk White	50kg	1-243-017
intivo	Silk White	30kg	1-246-015
	Silk White	50kg	1-246-017
	Terra Black	30kg	1-247-015
	Terra Black	50kg	1-247-017
	Stainless Steel	30kg	1-248-015
	Stainless Steel	50kg	1-248-017

450 mm Carcass - To suit 500 NL

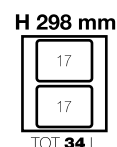

Description	Bucket Height	Drawer Nominal Length	Code
With Metal Lid	298mm	500mm	1-456-455
No Metal Lid	298mm	500mm	1-456-145

300 mm Carcass - To suit 500 NL

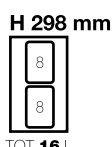

Description	Bucket Height	Drawer Nominal Length	Code
With Metal Lid	298mm	500mm	1-456-305
No Metal Lid	298mm	500mm	1-456-135

450 mm Carcass - To suit 500 NL

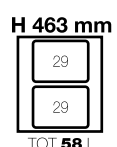

Description	Bucket Height	Drawer Nominal Length	Code
With Metal Lid	463mm	500mm	1-456-457
No Metal Lid	463mm	500mm	1-456-147

400 mm Carcass - To suit 500 NL

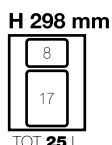

Description	Bucket Height	Drawer Nominal Length	Code
With Metal Lid	298mm	500mm	1-456-405
No Metal Lid	298mm	500mm	1-456-142

500 mm Carcass - To suit 500 NL

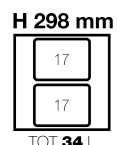

Description	Bucket Height	Drawer Nominal Length	Code
With Metal Lid	298mm	500mm	1-456-505
No Metal Lid	298mm	500mm	1-456-153

Waste Management Solutions



Top Hung Drawer 560 Waste Management Systems - To suit 500 NL

- Drawer not included with 560 waste codes
- Please select from the **TANDEMBOX 'M'** height drawer kits below

TANDEMBOX Program	Finish	Drawer Capacity	Code
antaro	Silk White	30kg	1-243-015
	Silk White	50kg	1-243-017
intivo	Silk White	30kg	1-246-015
	Silk White	50kg	1-246-017
	Terra Black	30kg	1-247-015
	Terra Black	50kg	1-247-017
	Stainless Steel	30kg	1-248-015
	Stainless Steel	50kg	1-248-017

600 mm Carcass - To suit 500 NL

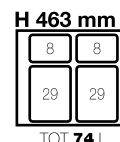

Description	Bucket Height	Drawer Nominal Length	Code
With Metal Lid	463mm	500mm	1-456-607
No Metal Lid	463mm	500mm	1-456-167

500 mm Carcass - To suit 500 NL

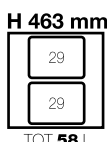

Description	Bucket Height	Drawer Nominal Length	Code
With Metal Lid	463mm	500mm	1-456-507
No Metal Lid	463mm	500mm	1-456-155

600 mm Carcass - To suit 500 NL

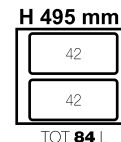

Description	Bucket Height	Drawer Nominal Length	Code
With Metal Lid	495mm	500mm	1-456-609
No Metal Lid	495mm	500mm	1-456-169

600 mm Carcass - To suit 500 NL

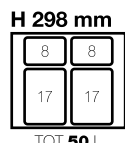

Description	Bucket Height	Drawer Nominal Length	Code
With Metal Lid	298mm	500mm	1-456-605
No Metal Lid	298mm	500mm	1-456-165

900 mm Carcass - To suit 500 NL

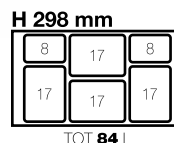

Description	Bucket Height	Drawer Nominal Length	Code
With Metal Lid	298mm	500mm	1-456-905
No Metal Lid	298mm	500mm	1-456-195

Waste Management Solutions

Top Hung Drawer 560 Waste Management Systems - To suit 450 NL



- Drawer not included with 560 waste codes
- Please select from the **TANDEMBOX 'M'** height drawer kits below

TANDEMBOX Program	Finish	Drawer Capacity	Code
antaro	Silk White	30kg	1-243-010
	Silk White	50kg	1-243-012

TANDEMBOX Program	Finish	Drawer Capacity	Code
intivo	Silk White	30kg	1-246-010
	Silk White	50kg	1-246-012
	Terra Black	30kg	1-247-010
	Terra Black	50kg	1-247-012
	Stainless Steel	30kg	1-248-010
	Stainless Steel	50kg	1-248-012

400 mm Carcass - To suit 450 NL



Description	Bucket Height	Drawer Nominal Length	Code
With Metal Lid	298mm	450mm	1-456-401
No Metal Lid	298mm	450mm	1-456-141

600 mm Carcass - To suit 450 NL

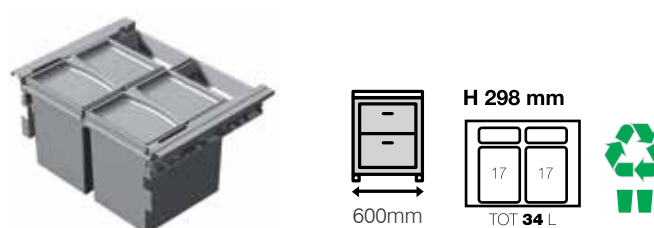

Description	Bucket Height	Drawer Nominal Length	Code
With Metal Lid	298mm	450mm	1-456-601
No Metal Lid	298mm	450mm	1-456-161

400 mm Carcass - To suit 450 NL

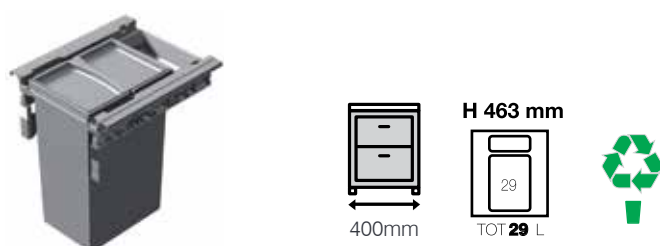

Description	Bucket Height	Drawer Nominal Length	Code
With Metal Lid	463mm	450mm	1-456-453
No Metal Lid	463mm	450mm	1-456-443

600 mm Carcass - To suit 450 NL



Description	Bucket Height	Drawer Nominal Length	Code
With Metal Lid	463mm	450mm	1-456-603
No Metal Lid	463mm	450mm	1-456-163

450 mm Carcass - To suit 450 NL



Description	Bucket Height	Drawer Nominal Length	Code
With Metal Lid	298mm	450mm	1-456-451
No Metal Lid	298mm	450mm	1-456-143

900 mm Carcass - To suit 450 NL

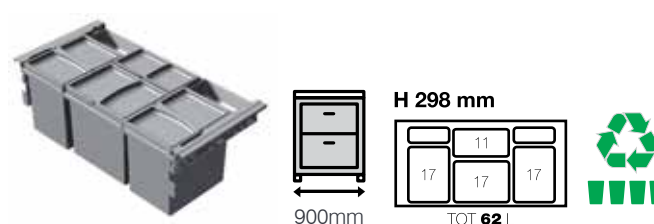

Description	Bucket Height	Drawer Nominal Length	Code
With Metal Lid	298mm	450mm	1-456-901
No Metal Lid	298mm	450mm	1-456-191

Waste Management Solutions

Installation

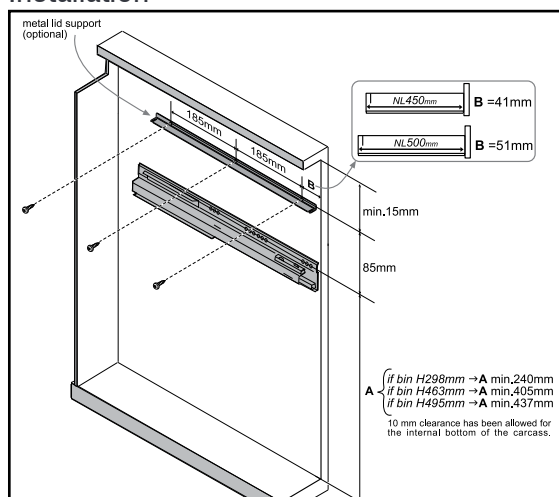

Blum TANDEMBOX carcass drawer runner & 560 metal lid position (optional)

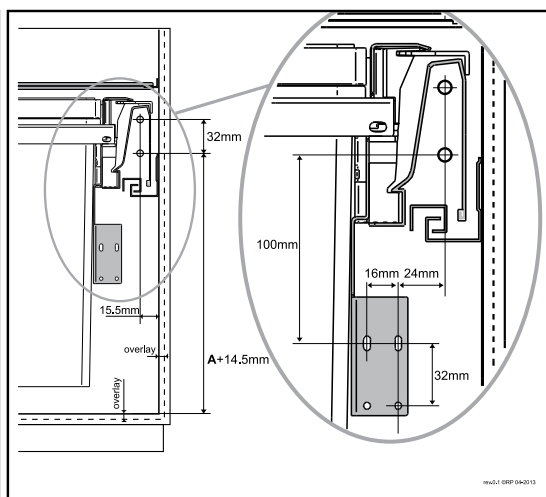

Blum TANDEMBOX drawer front drilling position & 560 additional support brackets

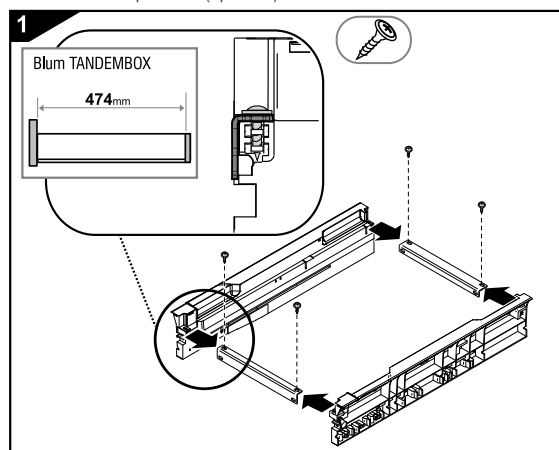

Assemble cross-rail and bin drawer profile

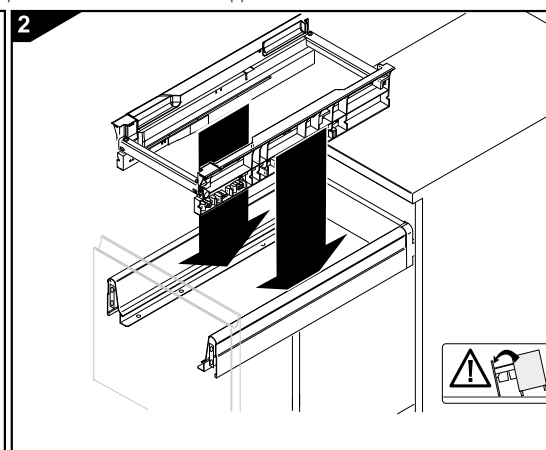

Place bin frame over drawer

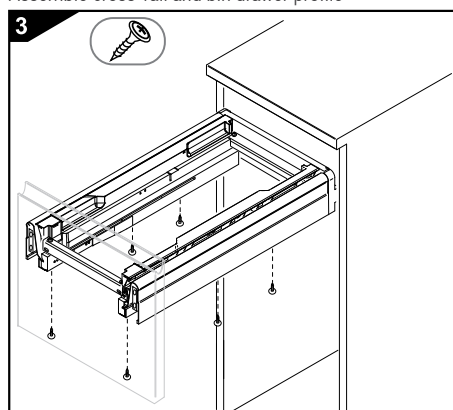

Fix bin frame to drawer

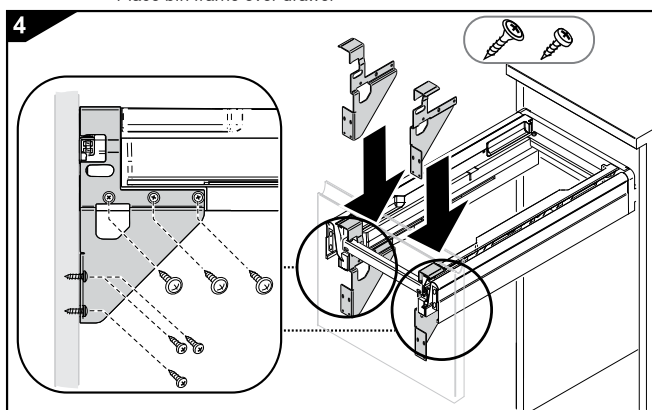

Assemble support bracket

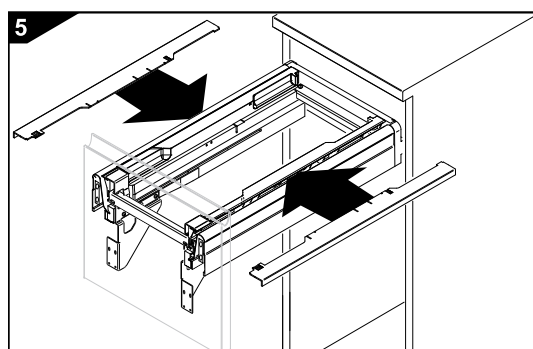

Install drawer profile covers

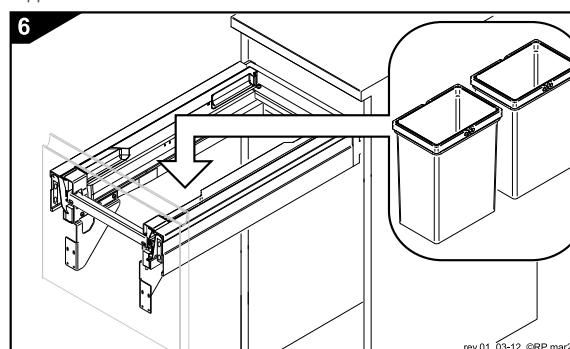

Place buckets into frame; Ready for front panel assembly; Screw off support brackets after final adjustments on site.

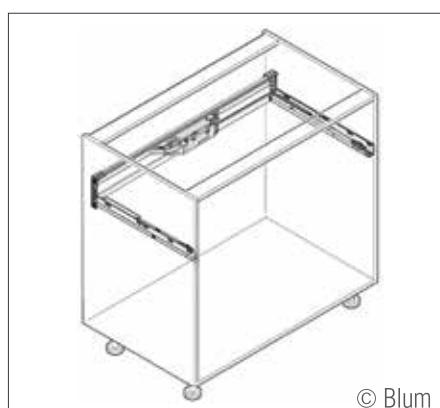

© Blum

SERVO-DRIVE uno

Your single touch waste pull out solution

Combine the Romagna 560 Waste Management with the automated Blum SERVO-DRIVE uno to provide the ultimate European waste combination.

- Suitable for 300 - 600 carcass width
- Fast and simple assembly
- Special feature to stop accidental opening
- Works with base-mounted and top-mounted waste systems
- Drip protection over drive unit
- Opens the pull out securely and easily
- Completely free-moving and can be stopped in any position
- Regardless of force, the pull out bin will close silently and effortlessly
- SERVO-DRIVE uno can be opened manually in the case of a power outage
- Standby power consumption is very minimal (3.5kWh per year)



SERVO-DRIVE uno Kit

© Blum

To Suit Carcass Cabinet	Description	Cut back metal chanel	Code
For Smaller than 450mm Carcass Cabinets Use 1-244-001 and trim			
450mm	SERVO-DRIVE uno		1-244-001
600mm	SERVO-DRIVE uno		1-244-003
For Smaller than 600mm but greater than 450mm Carcass Cabinets use either and trim			
300mm	SERVO-DRIVE uno	Cut back 150mm	1-244-001
400mm	SERVO-DRIVE uno	Cut back 50mm	1-244-001
500mm	SERVO-DRIVE uno	Cut back 100mm	1-244-003
For 900mm Carcass Cabinets refer to individual SERVO-DRIVE components			

Waste Management Solutions

Stand In Drawer Systems



RP921LS - 2 x 16 Litres

Features:

- Automatic lid
- Includes 1 main tray, 2 small removable trays, 2 buckets with handles designed to fit the liner
- Ideal for Blum TANDEMBOX drawers
- Perfect for recycling
- Optional: Single drawer bottom mounted kit
SERVO-DRIVE uno 1-244-003



Width	Depth	Height	Finish	Code
540mm	490mm	320mm	Grey	1-460-332



RP922LS - 3 x 16 Litres

Features:

- Automatic lid
- Includes 1 main tray, 3 small removable trays, 3 buckets with handles designed to fit the liner
- Ideal for Blum TANDEMBOX drawers
- Perfect for recycling
- SERVO-DRIVE option: speak to your local Territory Manager for component list



Width	Depth	Height	Finish	Code
840mm	490mm	320mm	Grey	1-460-303



RP906 - 2 x 14 Litres, 2 X 6.5 Litres

Features:

- Includes 1 main tray, 3 small removable trays, 4 buckets with handles designed to fit the liner
- Ideal for Blum TANDEMBOX drawers
- Perfect for recycling
- SERVO-DRIVE option: speak to your local Territory Manager for component list



Width	Depth	Height	Finish	Code
840mm	490mm	250mm	Grey	1-460-302



RP924LS - 3 x 16 Litres

Features:

- Automatic lid
- Includes 1 main tray, 2 chrome wire racks, 3 buckets with handles designed to fit the liner
- Ideal for Blum TANDEMBOX drawers
- Perfect for recycling
- SERVO-DRIVE option: speak to your local Territory Manager for component list



Width	Depth	Height	Finish	Code
1140mm	490mm	320mm	Grey	1-460-311

Waste Management Solutions

Free Standing Pull Out Systems



1-460-338

RP550 & RP551 - Pullout Bins

Features:

- Quartz/light grey finish
- Totally extractable steel ball slides
- Ideal for kitchens or laundries
- Can hold up to 25kgs

Description	Width	Depth	Height	Code
RP550- 2 x 35 Litres	380mm	493mm	578mm	1-460-334
RP551- 2 x 30 Litres	380mm	493mm	469mm	1-460-336
RP555 - Optional Door Mounting Kit - Metallic Grey Finish				1-460-338



RP503 - 2 x 16 Litres

Features:

- Patented automatic extraction mechanism
- Ball bearing slides
- Body & upper insert made of stainless steel

Width	Depth	Height	Finish	Code
343mm	477mm	366mm	Quartz Grey	1-460-330



RP226 - 20 Litres

Features:

- Strong, economical slide out bin
- Removable plastic bin
- Ideal for minimal space of 300mm cabinet
- Smooth running ball runners

Width	Depth	Height	Finish	Code
255mm	450mm	398mm	Light/Quartz Grey	1-460-224



RP227 - 2 x 14 Litres

Features:

- Durable design and tested to 100,000 cycles
- Top designed to rest sponges, gloves etc
- Colour coded buckets

Width	Depth	Height	Finish	Code
269mm	455mm	410mm	Cream/Green	1-460-225



RP250 - 2 x 14 Litres

Features:

- Patented automatic extraction mechanism
- Runs on ball bearing slides
- Stainless finish on buckets
- Durable design and tested up to 50,000 cycles with 10 kgs

Width	Depth	Height	Finish	Code
267mm	440mm	420mm	Quartz/Light Grey	1-460-308

Waste Management Solutions

Free Standing Pull Out Systems



Slide Out Bin - 2 x 16 Litres

Finista
FINISH WITH STYLE

Features:

- Grey plastic finish
- Metal frame
- 2 x individual buckets
- Quick installation under every kind of sink
- Full extension slides

Description	Width	Depth	Height	Code
RP - 291	343mm	473mm	339mm	2-460-099



Slide Out Bin - 1 x 16, 2 x 7.5 Litres

Finista
FINISH WITH STYLE

Features:

- Grey plastic finish
- Metal frame
- 3 x individual buckets
- Quick installation under every kind of sink
- Full extension slides

Description	Width	Depth	Height	Code
RP - 292	343mm	473mm	400mm	2-460-100



Pull Out Double Bin - 2 x 15 Litres

KIMBERLEY

Features:

- Concealed twin-bin separation system
- KRB06D allows attachment of fascia panel directly to bin

Description	Width	Depth	Height	Code
KRB08 - Plastic frame	350mm	525mm	340mm	1-460-099
KRB06 - Metal frame	350mm	525mm	340mm	1-460-101
KRB06D - Metal frame	350mm	525mm	340mm	1-460-100

KRB08 shown



Slide Out Bin

KIMBERLEY

Features:

- Removable bucket for easy cleaning
- Simple to install
- Smooth running ball race runners
- KRB15 comes with divider for waste separation

Description	Width	Depth	Height	Code
KRB12 -15L	266mm	390mm	334mm	1-460-096
KRB15 -44L	350mm	525mm	464mm	1-460-120

KRB15 shown

Waste Management Solutions

Door & Bench Systems



Single Kitchen Bin - 13 Litres

Features:

- Door mounted bin
- Lid opens by means of a patented automatic mechanism

Description	Width	Height	Finish	Code
RP272 - 13 Litres	277mm	355mm	White	1-460-326
RP272 - 13 Litres	277mm	355mm	Metallic Grey	1-460-328
RP270 - 13 Litres	277mm	355mm	White Plastic	1-460-322



Single Kitchen Bin - 5 Litres

Features:

- Ideal for the bathroom or office
- Lid opens by means of a patented automatic mechanism

Description	Width	Depth	Height	Finish	Code
RP208	218mm	208mm	235mm	White	1-460-320



Concealed Waste Bin - 30 Litres

KIMBERLEY

Features:

- Cam operated lid
- Removable for easy cleaning
- Right or left opening

Description	Width	Depth	Height	Finish	Code
KRB04	540mm	490mm	320mm	White	1-460-108



Bench Top Waste Bin - 10 Litres

Features:

- Perfect for the easy collection and removal of household bio degradable waste
- Stainless steel lid with ergonomic handle
- Stainless steel bucket
- Rubber ring supplied to seal lid
- Stainless steel collar to hide cut out
- Cut out diameter 235mm
- Total height 388mm

Overall Diameter	Finish	Code
250mm	Stainless Steel	1-460-236



KitVac Cupboard Vacuum System



- Very compact and clean
- Super filtration with 5-layer filter bag
- Fully automatic with a soft start motor (24 Months Warranty)
- Plugs into standard power point and then pre-cabled with 24V dustpan for easy connection
- Suitable for right or left side installation
- Non protruding kickboard dustpan, for a quick and easy clean

Waste Management Solutions

KitVac Cupboard Vacuum System



Push and it's on!



Quick and easy cleaning! Expand hose up to 5 metres.



Push the dustpan to start vacuuming.



Can you see it? Run extra dustpans off the one unit.

Features:

- Ideal for bathroom, laundry, rumpus, garage and enclosed outdoor areas
- Option to run dual dustpans and longer hoses
- Everything is supplied in the Kit - KitVac unit, dustpan, 5m expandable hose and accessories, hose bracket, special broom, flex pipe, fittings and all fixings
- Available in white, silver and black dustpan colours

Product specifications:

- The KitVac dimensions are: Depth 180mm, Width 280mm, Height 370mm
- Optimum cupboard side mount is right hand side and unit is already set up for this
- Unit can be changed to left hand side cupboard mount
- Uses standard 10 Amp power point, then low voltage cables (24 volts) are already connected to the unit and used for the dust pan
- The KitVac heppa bag holds approximately 2.75 litres of dry waste

Additional accessories available include:

- Premium Pack: Available in 9m and 12m hose lengths. Comes with hose and tool kit*
- Deluxe Pack: Available in 9m and 12m hose lengths. Comes with hose with on/off switch and tool kit*
- Protective Hose Sock

***Tool kit includes:** telescopic rod, combo floor tool, brush, crevice tool and hose hanger

KitVac White Dustpan Fittings		
Detail	Finish	Code
KitVac, KV-1000, KVV, Single Dustpan	White	1-652-060
KitVac, Expansion Set, EKW, Dustpan and fittings	White	1-652-064

KitVac Black Dustpan Fittings		
Detail	Finish	Code
KitVac, KV-1000, KVB, Single Dustpan	Black	1-652-070
KitVac, Expansion Set, EKB, Dustpan and fittings	Black	1-652-074

KitVac Silver Dustpan Fittings		
Detail	Finish	Code
KitVac, KV-1000, KVS, Single Dustpan	Silver	1-652-080
KitVac, Expansion Set, EKS, Dustpan and fittings	Silver	1-652-084

KitVac Replacement Bags		
Detail	Qty	Code
KitVac, Filter Bags, HF3	3 Bags included	1-652-000

KitVac Additional Accessories		
Detail	Description	Code
KitVac, Extra hose, HOS	Sold Per Metre	1-652-001
KitVac, 9M Premium, SH9	Hose Set & Tool Kit	1-652-002
KitVac, 12M Premium, S12	Hose Set & Tool Kit	1-652-004
KitVac, 9M Deluxe, SW9	Hose, Switch & Tool Kit	1-652-006
KitVac, 9M Hose Sock, SOC	Protective Hose Sock	1-652-007
KitVac, 12M Deluxe, SW1	Hose, Switch & Tool Kit	1-652-008
KitVac, 12M Hose Sock, SO1	Protective Hose Sock	1-652-009

Cutlery Trays



Scoop II Cutlery Trays

Features:

- Suits multiple applications, from the kitchen to the office
- High-impact polystyrene, 2.5mm thick
- Flexible slot in divider option allows the compartments to be arranged to suit requirements
- Comes in both white and silver grey in a variety of sizes

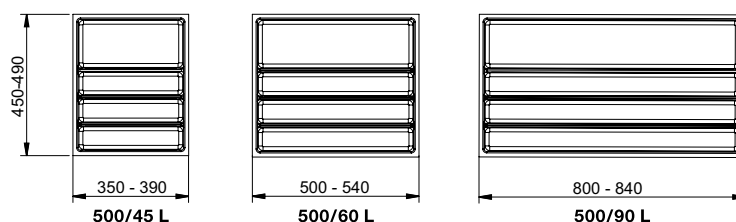

Type	Width		Depth		Height	Finish	Code
	Min	Max	Min	Max			
45L	350mm	390mm	450mm	490mm	60mm	White	1-452-750
45L	350mm	390mm	450mm	490mm	60mm	Grey	1-452-752
60L	500mm	540mm	450mm	490mm	60mm	White	1-452-758
60L	500mm	540mm	450mm	490mm	60mm	Grey	1-452-760
90L	800mm	840mm	450mm	490mm	60mm	White	1-452-762
90L	800mm	840mm	450mm	490mm	60mm	Grey	1-452-764

Accessories

Type	Finish	Code
Divider Set (3 x small, 1 x large)	White	1-452-770
Divider Set (3 x small, 1 x large)	Grey	1-452-772



Futura Cutlery Trays

Features:

- Wide compartments for larger utensils
- Create a individual multipurpose area with the slot-in dividers (sold separately)
- Comes in both white and silver grey in a variety of sizes

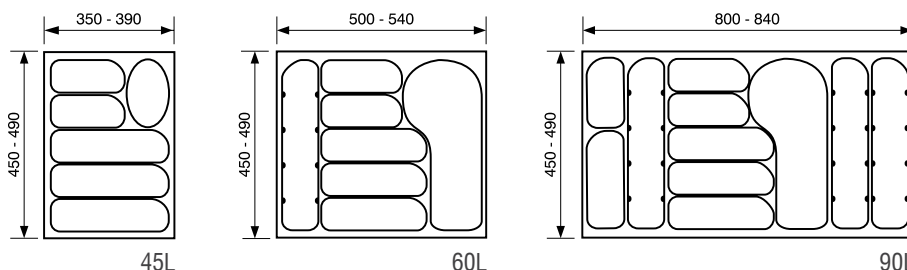

Type	Width		Depth		Height	Finish	Code
	Min	Max	Min	Max			
45L	350mm	390mm	450mm	490mm	60mm	White	1-452-540
45L	350mm	390mm	450mm	490mm	60mm	Grey	1-452-550
60L	500mm	540mm	450mm	490mm	60mm	White	1-452-543
60L	500mm	540mm	450mm	490mm	60mm	Grey	1-452-553
90L	800mm	840mm	450mm	490mm	60mm	White	1-452-545
90L	800mm	840mm	450mm	490mm	60mm	Grey	1-452-555

Accessories

Type	Finish	Code
Slot in Divider, Futura	White	1-452-537
Slot in Divider, Futura	Grey	1-452-547

Organisation Solutions

Cutlery Trays



Plastic Cutlery Insert Tray - Precut



Features:

- Precut to suit various cabinet sizes (see specifications below)
- Made from hygienic and easy to clean high impact styrene
- Gloss white finish

Width	Depth	Height	Code
322mm	372mm	55mm	1-450-120
372mm	372mm	55mm	1-450-122
422mm	372mm	55mm	1-450-124

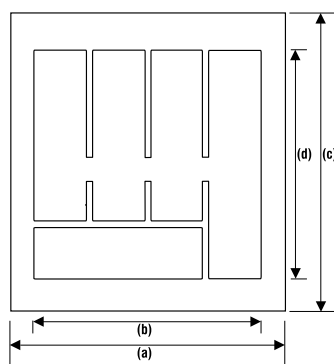

Plastic Cutlery Insert Tray - Uncut



Features:

- Trays have a wide rim, which can be cut down to the internal drawer dimensions with a circular saw
- Made from hygienic and easy to clean high impact styrene
- Gloss white finish

Width		Depth		Height	Code
Min (b)	Max (a)	Min (d)	Max (c)		
300mm	450mm	360mm	440mm	55mm	1-450-190

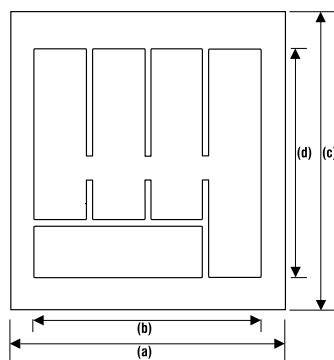

Plastic Cutlery Insert Tray - Uncut



Features:

- Trays have a wide rim, which can be cut down to the internal drawer dimensions with a circular saw
- Made from hygienic and easy to clean high impact styrene
- Gloss white finish

Width		Depth		Height	Code
Min (b)	Max (a)	Min (d)	Max (c)		
306mm	450mm	346mm	435mm	55mm	1-450-090
357mm	445mm	362mm	483mm	55mm	1-450-092



Vario Utensil Insert - Wide Drawers



Features:

- Utensil set for extra wide drawers
- Textured white finish

Type	Width	Depth	Height	Code
70L	700-740mm	435-500mm	52mm	1-450-166
80L	800-840mm	435-500mm	52mm	1-450-164

Organisation Solutions

Cutlery Trays & Spice Racks



Finista Cutlery Trays

Features:

- Suits METABOX drawers
- Available in cream and white finishes
- Tray height 55mm

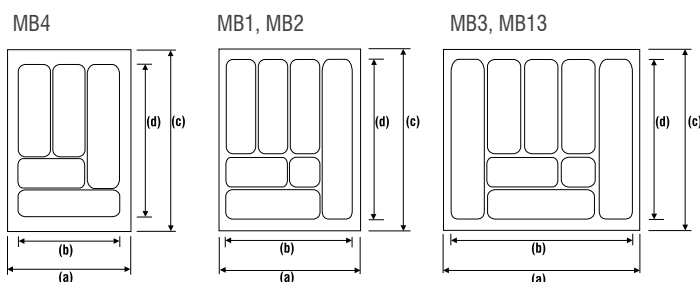

Description	Max Width (a)	Min Width (b)	Max Depth (c)	Min Depth (d)	Colour	Code
MB4	340mm	300mm	500mm	440mm	Cream	1-453-673
MB1	390mm	350mm	500mm	440mm	Cream	1-453-676
MB2	440mm	400mm	500mm	440mm	Cream	1-453-678
	440mm	400mm	500mm	440mm	White	1-453-664
MB3	540mm	500mm	500mm	440mm	Cream	1-453-680
	540mm	500mm	500mm	440mm	White	1-453-666
MB13	535mm	495mm	378mm	355mm	Cream	1-453-681



Spice Rack - Uncut

Features:

- Minimum drawer depth of 83mm required
- Tray has a wide rim, which can be cut down to the internal drawer dimensions
- Available in white

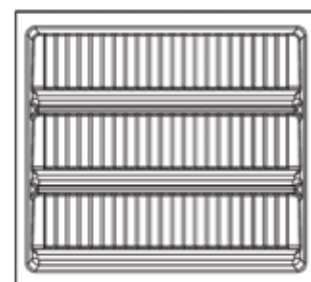

Max Width	Min Width	Max Depth	Min Depth	Colour	Code
540mm	500mm	490mm	440mm	White	1-450-195



Spice Rack

Features:

- Minimum drawer depth of 83mm required
- Can be cut to suit required drawer depth and width
- Available in cream and white

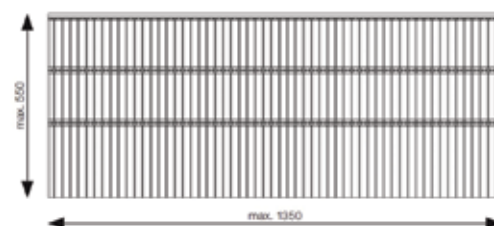

Width	Depth	Colour	Code
1350mm	550mm	Cream	1-450-094
1350mm	550mm	White	1-450-093

Organisation Solutions

Non-Slip Drawer Liner & Surface Saver



Finista Non-Slip Drawer Liner - Stipple



Features:

- Manufactured in Germany
- Stipple design
- Food grade polystyrene
- Prevents items sliding in drawers
- Easy to remove and clean if spillages occur, thick and durable

Description	Colour	Roll Width	Qty	Code
To Suit TANDEMBOX NL500mm	Grey	476mm	10m/Roll	1-452-080
To Suit TANDEMBOX NL500mm	Grey	476mm	25m/Roll	1-452-090
To Suit TANDEMBOX NL500mm	White	476mm	25m/Roll	1-452-095
To Suit TANDEMBOX NL550mm	Grey	526mm	25m/Roll	1-452-120
To Suit TANDEMBOX NL550mm	White	526mm	25m/Roll	1-452-121
To Suit TANDEMBOX NL650mm	Grey	626mm	10m/Roll	1-452-125
To Suit METABOX NL500mm	White	482mm	10m/Roll	1-452-055



Finista Non-Slip Drawer Liner - Corrugated



Features:

- Manufactured in Germany
- Corrugated design
- Food grade polystyrene
- Prevents items sliding in drawers
- Easy to remove and clean if spillages occur, thick and durable

Description	Colour	Roll Width	Qty	Code
To Suit TANDEMBOX	Grey	500mm	25m/Roll	1-452-007



Surface Saver

Features:

- Install on benchtop near cooktop to protect benchtop surface from hot items
- Non-porous tempered glass, heat and stain resistant
- Hygienic, stainless steel surrounding
- Overall cutout size: 519mm x 417mm (large), 391mm x 316mm (small)

Size	Finish	Width	Length	Code
Small	Ice White	330mm	408mm	1-483-520
Small	Almond	330mm	408mm	1-483-524
Large	Ice White	434mm	535mm	1-483-510
Large	Almond	434mm	535mm	1-483-514

Organisation Solutions

Pullout & Foldaway Fittings, Fridge Door Mounting Mechanism



Pullout Table Fitting

Features:

- Self-supporting, for 2 piece table tops and any desired cabinet width
- Either the front panel projects above the table top surface - or if the table top is to remain even - an additional blind panel must be mounted above the pull-out panel
- Finish: galvanised steel

Cabinet Width	Installation Height	Cabinet Depth	Load Capacity	Code
400-600mm	Min.130mm	Min. 500mm	30kgs	1-468-649
700-1200mm	Min.130mm	Min. 500mm	30kgs	1-468-650



Parallel Arm Foldaway Fitting

Features:

- For heavy kitchen appliances - 8kg load capacity (board included)
- For screw-mounting on the cabinet side panels
- In extended position, the appliance top is flush with the worktop
- Automatic locking after extension
- Locking release by lifting the appliance top
- Benchtop thickness: 25mm
- Max height: 400mm

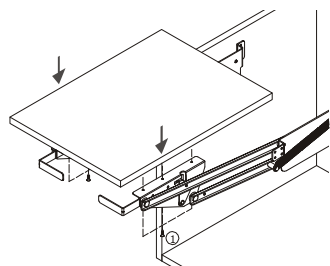
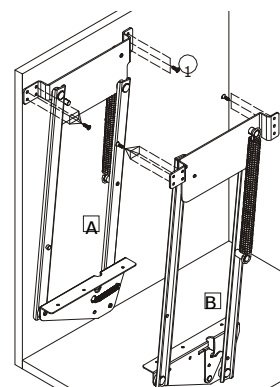

Foldaway Depth	Finish	Code
Min. 470mm	White	1-468-201



Fridge Door Mounting Mechanism

Features:

- Attach to fridge door and hinge front panel door for fridge concealment
- Action of sliding mechanism allows you to open the cabinet door while fridge door is being opened
- 4 fastening screws included

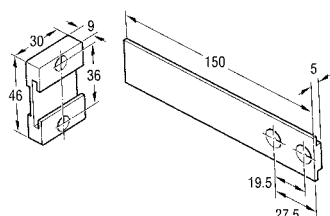
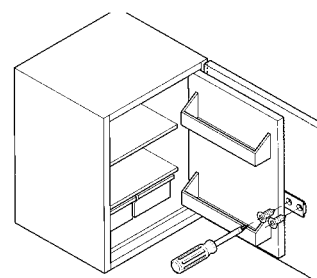
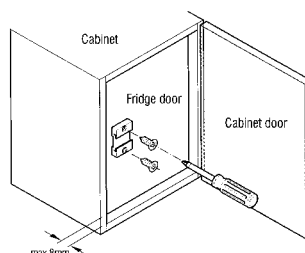

Length	Height	Finish	Code
150mm	46mm	Brown	1-460-230

Organisation Solutions

Hanging Rail System



Chrome Tube

Features:

- High quality chrome tubing for kitchen hanging system
- 1.2m long
- 16mm diameter

Description	Length	Diameter	Code
Chrome Tube	1.2m	16mm	1-478-180



Chrome Tube End Pillar Set

Features:

- Left hand and right hand set for hanging system
- Suits 16mm diameter chrome tube

Description	Code
Chrome Tube End Pillar Set	1-478-184



Chrome Tube Centre Pillar

Features:

- Centre pillar for hanging system
- Suits 16mm diameter chrome tube

Description	Code
Chrome Tube Centre Pillar	1-478-183



Chrome Hooks

- 5 Per Bag

Description	Code
Chrome Hooks	1-478-182



Cook Book Holder

- Size: 420mm (W) x 360mm (D) x 50mm (H)

Finish	Code
Chrome	1-478-177

Tea Towel Rails



Side Mount Tea Towel Rail - 2 Arm

Features:

- Ribbed plastic outer case that slides on anodised aluminium rods with in built tension device to resist turning
- Easily fixed to inside of cupboards and has telescopic arms for easy access

Length	Width	Height	Finish	Code
380mm-670mm	120mm	117mm	White Plastic	1-454-166



Side Mount Tea Towel Rail - 2 Arm

Features:

- Universal side-fix or top mount to inside or outside cupboards
- Integrated slide pull-out runner

Length	Width	Height	Finish	Code
440mm-720mm	95mm	40mm	Satin Aluminium	1-454-158



Side Mount Tea Towel Rail - 2 Arm

Features:

- Strong plated steel arms with protective ends
- Universal side-fix to inside or outside cupboards or on to any vertical surface
- Integrated slide pull-out runner

Length	Width	Height	Finish	Code
420mm-720mm	115mm	25mm	Chrome Plated	1-454-160



Side Mount Tea Towel Rail - 3 Arm

Features:

- Universal side-fix to inside or outside cupboards or on to any vertical surface
- Integrated slide pull-out runner

Length	Width	Height	Finish	Code
420mm-720mm	130mm	35mm	Chrome Plated	1-454-159

Storage Solutions

Storage Units & Racks



Hanging Basket & Hanging Support Set

Features:

- Hanging basket does not include hanging support set
- Finish: Chrome
- Hanging support sold in pairs



Hanging Support Set

Description	Width	Height	Depth	Code
Hanging Basket	470mm	85mm	110mm	1-478-190
Hanging Support Set				1-478-200

Wire Storage Racks

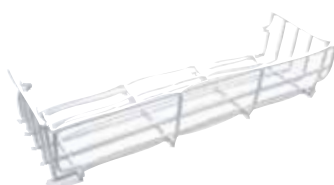

1-476-140



1-472-140

Features:

- Ideal for spice rack usage
- Durable plastic coating (white) or 18/8 grade rust-free polished stainless steel
- Ideal for pantries and internal cupboard doors
- Screw-mounting loop for easy installation

Description	Width	Depth	Height	Finish	Code
White Plastic-Coated Steel Racks	300mm	70mm	65mm	White	1-476-140
	300mm	115mm	110mm	White	1-476-142
	350mm	70mm	65mm	White	1-476-144
Stainless Steel Racks	300mm	70mm	65mm	Stainless Steel	1-472-140
	300mm	105mm	110mm	Stainless Steel	1-472-142
	350mm	70mm	65mm	Stainless Steel	1-472-146

Storage Solutions

Wine Glass Storage Solutions



Wine Glass Rack - 3 Row Closed End

Features:

- Top mounted
- Holds 12 standard wine glasses
- Chrome finish

Width	Depth	Finish	Code
330mm	310mm	Chrome	1-472-082



Wine Glass Rack - 3 Row Open Jumbo

Features:

- Top mounted
- Holds 18 standard wine glasses
- Allow 75mm space when adding more glass racks
- Chrome finish

Width	Depth	Finish	Code
270mm	400mm	Chrome	1-476-200



Wine Glass Rack - 3 Row Open Standard

Features:

- Top mounted
- Holds 12 standard wine glasses
- Allow 75mm space when adding more glass racks
- Chrome finish

Width	Depth	Finish	Code
270mm	270mm	Chrome	1-476-205



Wine Glass Rack - 2 Rows

Features:

- Holds 6 standard wine glasses
- Chrome finish

Width	Height	Depth	Finish	Code
205mm	65mm	340mm	Chrome	1-478-202



Wine Glass Rack - 1 Row

Features:

- Holds 3 standard wine glasses
- Chrome finish

Width	Height	Depth	Finish	Code
105mm	65mm	340mm	Chrome	1-478-204

Storage Solutions

Wine Bottle Storage Solutions

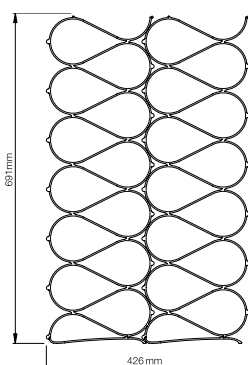
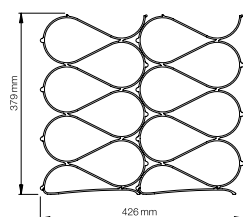

Echelon Wine Rack System

echelon

bottle storage system

Features:

- Modular bottle storage system
- Each kit includes 12 or 24 bottle modules, 2 base modules, 2 x steel rods, 2 x dowels, 4 x wall brackets
- Sized conveniently to fit in conventional kitchen and cabinet joinery
- The modular system allows to change components easily
- Space efficient, can fit 90 bottles per square metre
- Extra components available
- Can be secured to the wall



Description	Dimensions	Code
12 Bottle Kit	200mm	1-472-114
24 Bottle Kit	200mm	1-472-116

Description	Dimensions	Code
Bottle Module	200mm depth	1-472-100
Base Module	200mm depth	1-472-102
Wall Bracket		1-472-104
Stainless Steel Tube	6mm x 1200mm lengths	1-472-106



Wine Rack - Wall Mounted

Features:

- Suit min external cabinet width 400mm
- 12 bottle capacity
- Load capacity 50kg
- Chrome finish

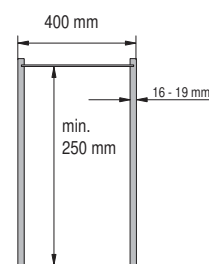

Width	Height	Depth	Finish	Code
308mm	458mm	190mm	Chrome	1-472-085



Finish with Style with the Finista range



Finish your next project with style by integrating the new Finista range of products from Lincoln Sentry.

Finista is a range of stylish solutions for the kitchen, bathroom, wardrobe, laundry and office.

This new range of Finista products have been sourced from all over the globe and will allow you to offer your customers a selection of products that will "finish with style" your next project.

Finista
FINISH WITH STYLE

Kitchen & Laundry Solutions

Ironing Boards



Drawer Pullout Ironing Board



Features:

- Drawer pullout system
- Conceals ironing board behind a drawer for easy access
- Full extension slides
- Cabinet requirements: external cabinet width: 400mm - 500mm, minimum internal cabinet depth: 510mm, minimum internal cabinet height: 120mm
- Board size: 950mm x 300mm

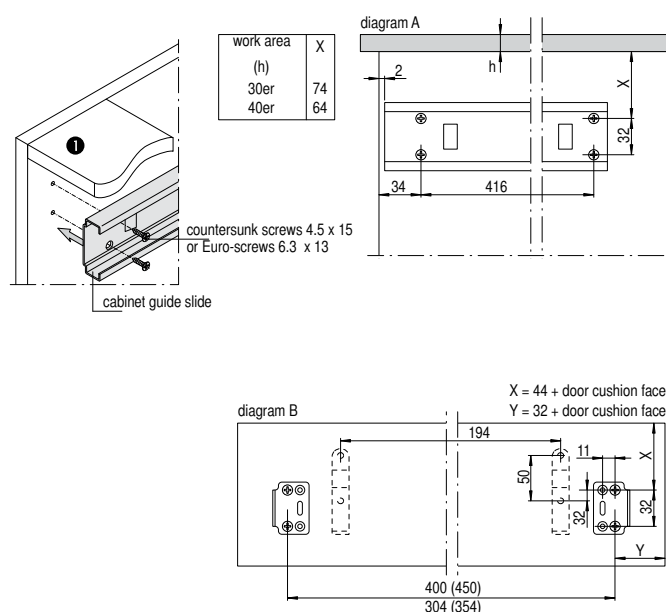

External Cabinet Width	Finish	Code
400mm - 500mm	White	1-468-040
Ironing Board Cover - Replacement		1-467-033



Finista Laundry Valet



Features:

- Wall mount
- Chrome plated steel frame
- Adjustable height
- Holds six items

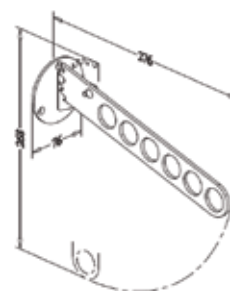

Length	Depth	Height	Code
276mm	76mm	268mm	1-472-021

Kitchen & Laundry Solutions

Ironing Boards & Laundry Accessories



Finista Pullout Ironing Board

Features:

- Universal left or right hand installation
- Chrome plated steel frame
- Soft close runner
- Min cabinet depth 400mm
- Min cabinet width 200mm
- Length when folded out 950mm
- Adjustable feet + or - 65mm

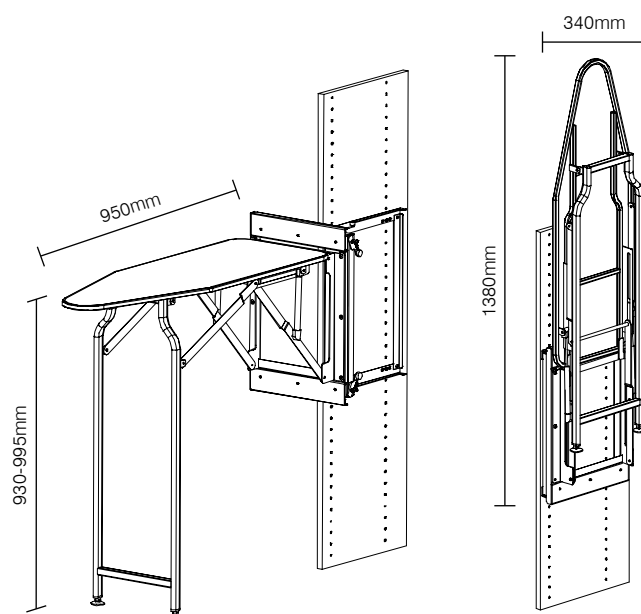

Width	Depth	Height	Code
140mm	340mm	1380mm	1-472-022



Finista Iron Holder

Features:

- Wall mount
- Chrome plated steel frame

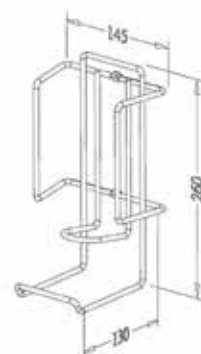

Width	Depth	Height	Code
145mm	130mm	260mm	1-472-020

Kitchen & Laundry Solutions

Laundry Accessories



Vauth-Sagel Tilt 3-Sided Basket



VAUTH-SAGEL

Features:

- Tilt down action
- Door mounted
- Ideal for laundry basket use
- Hinges not included (order separate)
1 x 1-366-772 & 1 x 1-366-774

External Cabinet Width	Internal Cabinet Depth	Internal Cabinet Height	Finish	Code
380mm	470mm min	450mm min	Chrome	1-470-515

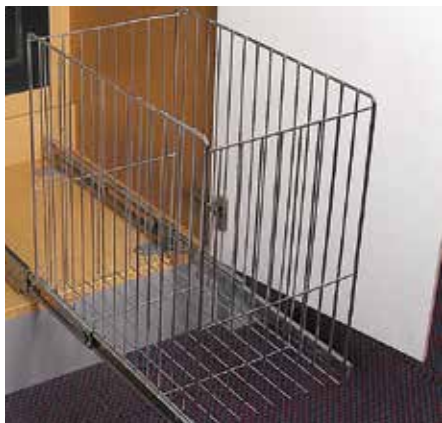

Vauth-Sagel Pull-Out Tall Basket



VAUTH-SAGEL

Features:

- Base mounted
- Full extension
- Ideal for laundry basket use

Cabinet Width	Internal Cabinet Depth	Internal Cabinet Height	Finish	Code
310mm min	460mm min	460mm min	Chrome	1-470-520

Kitchen & Laundry Solutions

Laundry Accessories



Finista Vacuum Cleaner Storage Pullout Rack

Finista
FINISH WITH STYLE

Features:

- Universal left or right hand installation
- Chrome plated steel frame
- Soft close runner
- Load capacity 40kg
- Minimum cabinet depth 500mm
- Minimum cabinet width 400mm

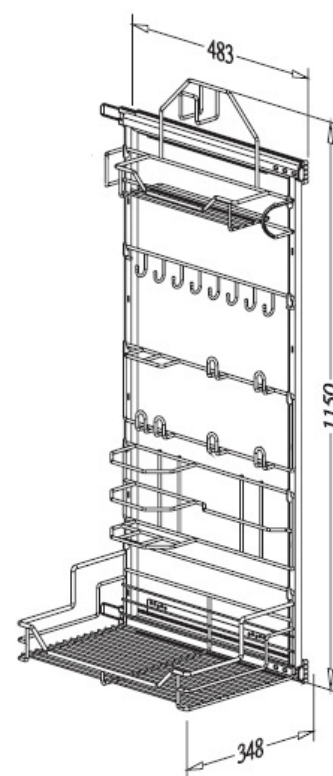

Width	Depth	Height	Code
348mm	483mm	1150mm	1-472-023



Broomstick Holder With Rubber Rollers

Features:

- Material - galvanised steel/rubber
- Wall mount
- Suits 23-28mm broomstick

Width	Height	Depth	Code
51mm	50mm	40mm	1-468-045

Kitchen & Laundry Solutions

Vents



Aluminium Multi-Purpose Vent

Cutting Size (L x W)	Overall Size (L x W)	Finish	Code
278mm x 65mm	300mm x 80mm	Anodised Aluminium	1-477-900



Cupboard Vent - Round

- Plastic

Cutting Size	Overall Size	Finish	Code
Ø 28mm	Ø 40mm	White	1-477-912
Ø 28mm	Ø 40mm	Black	1-477-909



Medium Cupboard Vent - Rectangular

- Plastic

Cutting Size (L x W)	Overall Size (L x W)	Finish	Code
124mm x 60mm	135mm x 80mm	White	1-477-915



Large Cupboard Vent - Rectangular

- Plastic

Cutting Size (L x W)	Overall Size (L x W)	Finish	Code
216mm x 108mm	245mm x 130mm	White	1-477-918



Wall / Door Vent - Rectangular

- Plastic

Cutting Size (L x W)	Overall Size (L x W)	Finish	Code
216mm x 115mm	230mm x 130mm	White	1-477-921



Call your nearest branch on:

Ph: 1300 551 919

Fax: 1300 739 656

www.lincolnsentry.com.au

Queensland
Coopers Plains
Bundaberg
Cairns
Gold Coast
Mackay
Rockhampton
Sunshine Coast
Toowoomba
Townsville

New South Wales
Prestons
Alexandria
Albury
Coffs Harbour
Newcastle
Australian Capital Territory
Fyshwick

Victoria
Bayswater
Dandenong
Bendigo
Geelong

South Australia
Lonsdale

Northern Territory
Winnellie

Tasmania
Launceston

Western Australia
Malaga
Bunbury

BR0035CH

 **LINCOLN**
S E N T R Y